

19/720 Old Princes Hwy, Sutherland, NSW 2232

Leased - \$610 per Week

Unit 2  2  1 



### Low Maintenance, modern

Two bedroom apartment on the 4th floor, featuring panoramic views over Botany Bay, Sydney basin and Blue Mountains.

Elevator access to this North aspect sunny location with L shaped living area and open floor plan.

Main bedroom has ensuite bathroom and second bedroom has balcony access. Panoramic views from each bedroom.

Luxuriously appointed kitchen featuring Dishwasher, Microwave oven and gas cook top.

Internal laundry with dryer, double door linen press, security car space and separate storeroom.

Available: 7th April, 12 month lease

### Open for Inspection

By Appointment.

### Listed By

Dominika Magrys

Phone: (02) 9521 4644



Floorplan



# Parc



720 Princes Highway, Sutherland



## Apartment 19- Fourth Floor

Apartment Area:	89m <sup>2</sup>
Balcony Area:	13m <sup>2</sup>
Car Park Area:	18m <sup>2</sup>
Storage Area:	5m <sup>2</sup>
Total Area	125m <sup>2</sup>

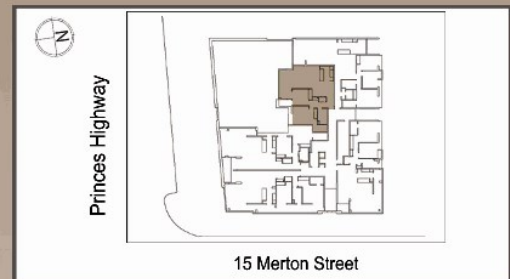

Please note: all stated dimensions are approximate only. Particulars given are general information only and do not constitute any representation on the part of the vendor or agent

